



Uconnect® 5.0

Owner's Manual Supplement

TABLE OF CONTENTS

SECTION		PAGE
1	IDENTIFYING YOUR RADIO	3
2	RADIO MODE	7
3	MEDIA MODE	13
4	UCONNECT® PHONE	19
5	UCONNECT® VOICE COMMAND	25
6	SETTINGS MAIN MENU	33
7	MORE MAIN MENU	35
8	SAFETY GUIDELINES	37

IDENTIFYING YOUR RADIO

CONTENTS

- Identifying Your Radio 4
- Uconnect® 5.0 System 5

4 IDENTIFYING YOUR RADIO

Identifying Your Radio

Uconnect® 5.0



Key Features

- 5" Touch-Screen
- Three hard-keys on either side of the display
- Hands-free/Bluetooth®
- SiriusXM Satellite Radio Optional

Uconnect® 5.0 System

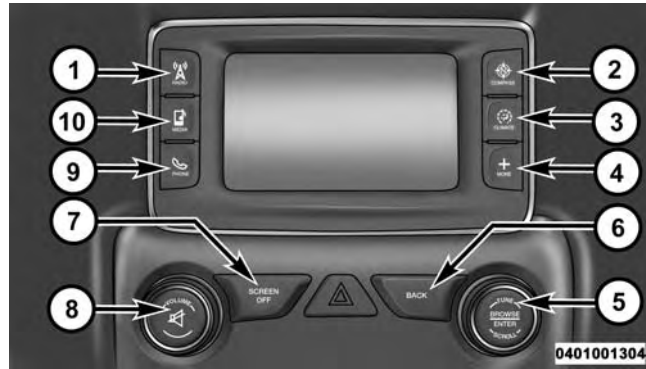

1. RADIO

Press the RADIO hard-key to enter the Radio Mode. The different tuner modes; AM, FM and SXM – If Equipped can be selected by touching the corresponding soft-keys in the Radio Mode.

2. COMPASS

Press the COMPASS hard-key to display the current direction of the vehicle.

3. CLIMATE

Press the CLIMATE hard-key to access the Climate Controls.

4. MORE

Press the MORE hard-key to access additional options.

5. ENTER/BROWSE & TUNE/SCROLL

Press the ENTER/BROWSE button to accept a highlighted selection on the screen. Rotate the TUNE/SCROLL rotary knob to scroll through a list or tune a radio station.

6. BACK

Press the BACK button to return to a previous menu or screen.

7. SCREEN OFF

Press the SCREEN OFF hard-key to turn the touch-screen OFF. To turn the screen back ON, just touch the screen.

8. VOLUME & MUTE

Rotate the rotary knob to adjust the Volume. Press the Mute button to mute the system.

9. PHONE

Press the Phone button to access the Uconnect® Phone feature.

10. MEDIA

Pressing the MEDIA button will allow you to switch to Media mode (CD, USB/iPOD, AUX, Bluetooth).

RADIO MODE

CONTENTS

■ Radio Mode	8
------------------------	---

Radio Mode

The radio is equipped with the following modes:

- AM
- FM
- SXM Sirius XM Satellite Radio (if equipped)

Touch the RADIO hard-key, to enter the Radio Mode. The different tuner modes; AM, FM, and SXM, can then, be selected by touching the corresponding soft-keys in the Radio mode.

Volume & Mute

- Rotate the rotary knob to adjust the Volume. When the audio system is turned on, the sound will be set at the same volume level as last played.
- Press the Mute button to mute the system. Press the Mute button again to un-mute the system.

Enter/Browse & Tune/Scroll Control

- Turn the rotary TUNE/SCROLL control knob clockwise to increase or counterclockwise to decrease the radio station frequency. Push the ENTER/BROWSE button to choose a selection.

Seek Functions

Seek Up

- Touch and release the Seek Up soft-key to tune the radio to the next listenable station or channel.
- During a Seek Up function, if the radio reaches the starting station after passing through the entire band two times, the radio will stop at the station where it began.

Fast Seek Up

- Touch and hold the Seek Up soft-key to advance the radio through the available stations or channels at a faster rate, the radio stops at the next available station or channel when the soft-key is released.

Seek Down

- Touch and release the Seek Down soft-key to tune the radio to the next listenable station or channel.
- During a Seek Down function, if the radio reaches the starting station after passing through the entire band two times, the radio will stop at the station where it began.

Fast Seek Down

- Touch and hold the Seek Down soft-key to advance the radio through the available stations or channel at a faster rate, the radio stops at the next available station or channel when the soft-key is released.

Setting Presets

The Presets are available for all Radio Modes, and are activated by touching any of the four Preset soft keys, located at the top of the screen.

When you are receiving a station that you wish to commit into memory, press and hold the desired numbered soft-key for more than 2 seconds or until you hear a confirmation beep.

The Radio stores up to 12 presets in each of the Radio modes. 4 presets are visible at the top of the radio screen.

Touching the “all” soft-key on the radio home screen will display all of the preset stations for that mode.

SiriusXM Satellite Radio Mode

SiriusXM Satellite Radio uses direct satellite-to-receiver broadcasting technology to provide clear, coast to coast radio content. SiriusXM is a subscription based service.

SiriusXM Premier

Get over 160 channels on your satellite radio, and enjoy all you want, all in one place. Hear commercial-free music plus sports, news, talk and entertainment. Get all the premium programming, including Howard Stern, every NFL game, Oprah Radio®, every MLB® and NHL® game, every NASCAR® race, Martha Stewart and more. And get 20+ extra channels, including SiriusXM Latino, offering 20 channels of commercial free music, news, talk, comedy, sports and more dedicated to Spanish language programming.

SiriusXM services require subscriptions, sold separately after the 12-month trial included with the new vehicle

purchase. If you decide to continue your service at the end of your trial subscription, the plan you choose will automatically renew and bill at then-current rates until you call SiriusXM at 1-866-635-2349 to cancel. See SiriusXM Customer Agreement for complete terms at www.siriusxm.com. All fees and programming subject to change. Our satellite service is available only to those at least 18 and older in the 48 contiguous USA and D.C. Our Sirius satellite service is also available in PR (with coverage limitations). Our Internet radio service is available throughout our satellite service area and in AK and HI. © 2012 Sirius XM Radio Inc. Sirius, XM and all related marks and logos are trademarks of Sirius XM Radio Inc. Service available in Canada; see www.siriuscanada.ca.

This functionality is only available for radios equipped with a Satellite receiver. In order to receive satellite radio, the vehicle needs to be outside with a clear view to the sky.

If the screen shows Acquiring Signal, you might have to change the vehicle's position in order to receive a signal. In most cases, the satellite radio does not receive a signal in underground parking garages or tunnels.

Audio

1. Press the SETTINGS hard-key on the right side of the unit.
2. Then scroll down and press the Audio soft-key to get to the Audio menu.
3. The Audio Menu shows the following options for you to customize your audio settings.

Equalizer

- Touch the Equalizer soft-key to adjust the Bass, Mid and Treble. Use the + or - soft-key to adjust the equalizer to your desired settings. Press the back arrow soft-key when done.

Balance/Fade

- Touch the Balance/Fade soft-key to adjust the sound from the speakers. Use the arrow soft-key to adjust the sound level from the front and rear or right and left side speakers. Touch the Center "C" soft-key to reset the balance and fade to the factory setting. Press the back arrow soft-key when done.

Speed Adjustable

- Touch the Speed Adjusted Volume soft-key to select between OFF, 1, 2 or 3. This will decrease the radio volume relative to a decrease in vehicle speed. Press the back arrow soft-key when done.

Loudness

- Touch the Loudness soft-key to select the Loudness feature. When this feature is activated it improves sound quality at lower volumes.

Clock Setting

There are two ways to enter the clock setting procedure on the Uconnect® 5.0 system.

1. Press the More hard-key on the right side of the display, next press the Time soft-key and then press the Set soft-key. **OR** Press the More hard key on the right side of the display, next press the Settings soft key, then Clock and Date soft key, and then Set Time and Date soft key. Select the up or down arrows as appropriate. Select Done when complete.
2. Touch the Up or Down arrows to adjust the hours or minutes, next select the AM or PM soft-key. You can also select 12hr or 24hr format by touching the desired soft-key.
3. Once the time is set press the “Done” soft-key to exit the time screen.

NOTE: In the Clock Setting Menu you can also select Display Clock. Display Clock turns the clock display in the status bar on or off.

MEDIA MODE

CONTENTS

■ Media Mode14
------------------------	-----

Media Mode

Media Mode is entered by touching the Media hard-key located on the side of the display. Once in Media Mode, touch Source soft-key and the desired mode soft-key. Disc, USB, AUX and Bluetooth are the Media sources available. You can select the Browse soft key to be given these options: Now Playing, Artists, Albums, Genres, Songs, Playlists or Folders. You can select the Source soft key, Pause/Play soft key, Info soft key for artist information on current song playing.

Common Media Functions

Seek Up/Down

Touch and release the right arrow soft-key for the next selection. Touch and release the left arrow soft-key to return to the beginning of the current selection, or return to the beginning of the previous selection if the Disc is within the first second of the current selection.

Fast Seek Up: Touch and hold the right arrow soft-key and the desired mode will begin to fast forward through the current track until the soft-key is released.

Fast Seek Down: Touch and hold the left arrow soft-key and the desired mode will begin to rewind through the current track until the soft-key is released.

Source

Touch the Source soft-key to select the desired audio source, Disc, AUX or USB/iPod®. This screen will time out after a few seconds and return to the main radio screen if no selection is made.

Info

Touch the Info soft-key to display the current track information. Touch the "X" soft-key to cancel this feature.

Shuffle

Touch the shuffle soft-key to play the selections on the USB/iPod® device in random order to provide an interesting change of pace. Touch the soft-key a second time to turn this feature off.

Audio

Refer to Operating Instructions – Radio Mode for adjusting the audio settings.

Disc Mode

If Equipped, your vehicle may have a remote Disc player located in the center console storage bin.

Disc Mode is entered by either inserting a CD/Disc or by touching the Media hard-key located on the side of the display. Once in Media Mode, touch the source soft-key and select Disc.

Inserting Compact Disc

Gently insert one Disc into the Disc player with the Disc label following the illustration indicated on the player. The Disc will automatically be pulled into the Disc player and the Disc icon will illuminate on the radio display. If a Disc does not go into the slot more than 1.0 in (2.5 cm), a disc may already be loaded and must be ejected before a new Disc can be loaded.

If you insert a Disc with the ignition ON and the radio ON, the unit will switch to Disc mode and begin to play when you insert the Disc. The display will show the track number, and index time in minutes and seconds. Play will begin at the start of track 1.

Browse

Touch the browse soft-key to scroll through and select a desired track on the Disc. Touch the exit soft-key if you wish to cancel the browse function.

Eject Button – Ejecting a Disc

Press the EJECT button to eject the Disc. If you have ejected a Disc and have not removed it within 10 seconds, it will be reloaded. If the Disc is not removed, the radio will reinsert the Disc but will not play it.

A Disc can be ejected with the radio and ignition OFF.

USB/iPod® Mode

USB/iPod® Mode is entered by either inserting a USB Jump Drive or iPod® cable into the USB port or by touching the Media hard-key located left of the display. Once in Media Mode, touch the source soft-key and select USB/iPod®.

Inserting USB/iPod® Device

Gently insert the USB/iPod® device into the USB Port. If you insert a USB/iPod® device with the ignition ON, the unit will switch to USB/iPod® mode and begin to play

when you insert the device. The display will show the track number, and index time in minutes and seconds. Play will begin at the start of track 1.

Browse

Touch the Browse soft-key to select Artist, Albums, Genres, Songs, Playlists or Folders from the USB/iPod® device. Once the desired selection is made you can chose from the available media by touching the soft-key. Touch the exit soft-key if you wish to cancel the browse function.

AUX Mode

AUX Mode is entered by inserting a AUX device using a cable with a 3.5 mm audio jack into the AUX port or by touching the Media hard-key located left of the display. Once in Media Mode, touch the source soft-key and select AUX.

Inserting Auxiliary Device

Gently insert the Auxiliary device cable into the AUX Port. If you insert a Auxiliary device with the ignition ON, the unit will switch to AUX mode and begin to play when you insert the device cable.

Controlling the Auxiliary Device

The control of the auxiliary device (e.g., selecting playlists, play, fast forward, etc.) cannot be provided by the radio; use the device controls instead. Adjust the volume with the VOLUME rotary knob, or with the volume of the attached device.

NOTE: The vehicle radio unit is acting as the amplifier for audio output from the Auxiliary device. Therefore if the volume control on the Auxiliary device is set too low, there will be insufficient audio signal for the radio unit to play the music on the device.

Bluetooth® Mode

Bluetooth® Streaming Audio (BTSA) or Bluetooth® Mode is entered by pairing a Bluetooth® device, containing music, to the Uconnect® system.

Before proceeding, the Bluetooth® device needs to be paired through Uconnect® Phone in order to communicate with the Uconnect® system.

NOTE: See the pairing procedure in the in this manual for further details.

Once the Bluetooth® device is paired to the Uconnect® system, touch the Media hard-key located on the left side of the display. Once in Media Mode, touch the source soft-key and select Bluetooth®.

Uconnect® Phone

CONTENTS

■ Uconnect® Phone.20
----------------------------	-----

Uconnect® Phone

The Uconnect® Phone is a voice-activated, hands-free, in-vehicle communications system with Voice Command Capability (see Voice Command section).

The Uconnect® Phone allows you to dial a phone number with your mobile phone using simple voice commands.

NOTE:

- The Uconnect® Phone requires a mobile phone equipped with the Bluetooth® Hands-Free Profile, Version 1.0 or higher. For Uconnect® customer support:
 - U.S. residents - visit www.UconnectPhone.com or call 1-877-855-8400
 - Canadian residents - call 1-800-465-2001 (English) or 1-800-387-9983 (French)

- Prior to starting the pairing procedure, ensure all additional Bluetooth® devices or phones within the vehicle have their Bluetooth® disabled.

Pairing a Phone

To use the Uconnect® Phone feature, you must first pair your Bluetooth® phone with the Uconnect® system. Refer to www.UconnectPhone.com for pairing procedure unique to your phone.

Start Pairing Procedure

- Activate the Bluetooth® on your mobile phone.
- Press the Phone button on the radio faceplate.
- If no phone is paired with the system, the display shows a dedicated screen.
- Touch the Yes soft-key to start the pairing procedure the search for the Uconnect® device on the mobile phone (if No is selected, the Phone main screen is displayed).

- When prompted by the mobile phone, use its keyboard to enter the PIN code shown on the system display or confirm on the mobile phone the PIN displayed.
- From the Phone screen you can always pair a mobile phone pressing the Settings button and then touch the Add Device soft-key and proceed as described above.
- During the pairing stage a screen is displayed showing the progress of the operation.
- If the pairing procedure is completed successfully, a screen is displayed. Touch Yes to the question to pair the mobile phone as favorite (the mobile phone will have priority on all other mobile phones that will be paired later on). If no other devices are paired, the system will consider the first associated device as favorite.

NOTE:

- The priority is determined according to the order of connection for mobile phones which are not set as favorite. The last phone connected will have the highest priority.
- For assistance in pairing your phone, contact Uconnect® customer support:
 - U.S. residents - visit www.UconnectPhone.com for phone compatibility, pairing instructions and details or call 1-877-855-8400
 - Canadian residents - call 1-800-465-2001 (English) or 1-800-387-9983 (French)

Phonebook Download – Phonebook Transfer From Mobile Phone

If equipped and specifically supported by your phone, Uconnect® Phone will ask you if you want to download names (text names) and number entries from your mobile phone's phonebook. Specific Bluetooth® Phones with Phone Book Access Profile may support this feature. See www.UconnectPhone.com for supported phones.

Download and update, if supported, begins as soon as the Bluetooth® wireless phone connection is made to the Uconnect® Phone, for example, after you start the vehicle.

NOTE:

- You may be asked for permission to initiate the phonebook download.
- A maximum of 2000 entries per phone will be downloaded and updated every time a phone is connected to the Uconnect® Phone.

- Depending on the maximum number of entries downloaded, there may be a short delay before the latest downloaded names can be used. Until then, if available, the previously downloaded phonebook is available for use.
- Only the phonebook of the currently connected mobile phone is accessible.
- Only the mobile phone's phonebook is downloaded. SIM card phonebook is not part of the Mobile phonebook.
- This downloaded phonebook cannot be edited or deleted on the Uconnect® Phone. These can only be edited on the mobile phone. The changes are transferred and updated to Uconnect® Phone on the next phone connection.

Making A Phone Call

Press the “Phone” button.

(After the BEEP), say “dial” (or “call” a name).

Receiving A Call – Accept (And End)

When an incoming call rings or is announced on Uconnect®, press the Phone button.

To end a call, press the Phone button on steering wheel or the Phone soft-key on the radio screen.

Mute (Or Unmute) Microphone During Call

During a call, press the “Voice Command” button.

(After the BEEP), say “mute” (or “mute off”).

Transfer Ongoing Call Between Handset And Vehicle

During a call, press the “Voice Command” button.

(After the BEEP), say “transfer call”.

Changing The Volume

Start a dialogue by pressing the “Phone” button , then adjust the volume during a normal call.

Use the radio VOLUME rotary knob to adjust the volume to a comfortable level while the Uconnect® system is speaking. Please note the volume setting for Uconnect® is different than the audio system.

Uconnect® VOICE COMMAND



CONTENTS

■ Uconnect® 5.0 Voice Command Quick Reference26
--	-----

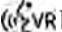
Uconnect® 5.0 Voice Command Quick Reference

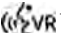
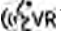
If the Uconnect Voice Command  button exists on your steering wheel, you have the Voice Command feature, which is optimized for the driver. The Voice Command feature lets you keep your hands on the wheel, and your eyes on the road.

When you press the Voice Command  button located on the steering wheel, you will hear a beep. After the beep, give your command. If you do not know what commands to say, you can say “help” and the system will provide options to you. If you ever wish to interrupt the system while it lists options, press the Voice Command  button, after the beep, say your command.



NOTE: All phone oriented voice commands are accessible by first pressing the Phone Pick Up  button, not the Voice Command button. To end a call, simply press the Phone Hang Up  button. In some vehicles, the Phone Pickup button serves the dual purpose of ending calls as well.

Voice Command (VR) User TIPS

- To hear available commands, press the Uconnect® Voice Command button and say “Help”. You will hear available commands for the menu displayed.
- At any time, you can say the words “Cancel” or “Help”. These commands are universal and can be used from virtually any menu. All other specific commands can be used depending upon the active application.

- You can interrupt the system prompts at any time by pressing the Uconnect® Voice Command button while the system is speaking. After the beep, you can say a command.
- You can 'chain' commands together for faster results. Say "Call Joe Doe mobile", for example.
- For best performance, adjust the rearview mirror to provide at least 1/2 in (1 cm) gap between the overhead console (if equipped) and the mirror.
- Always wait for the beep before speaking.
- Speak normally, without pausing, just as you would speak to a person sitting a few feet/meters away from you.
- Make sure that no one other than you is speaking during a Voice Command period.

Steering Wheel Buttons

You can control many of your radio features using your voice. Press either the VR  or Phone Pick Up  button on your steering wheel.

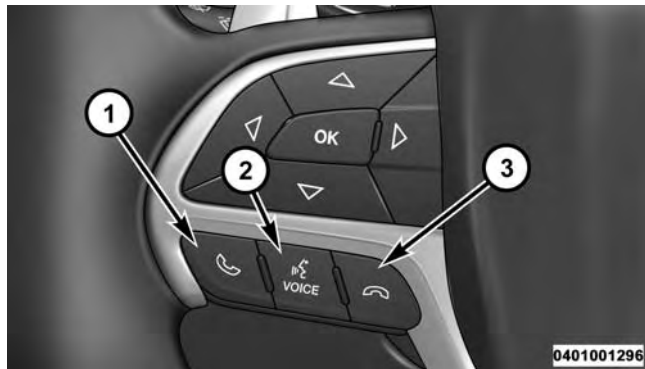

1. Uconnect® Phone Pick Up Button
2. Uconnect® Voice Command (VR) Button
3. Phone Hang Up Button

Available Radio Button Voice Commands



Types of Voice Commands Available	Steering Wheel Buttons to Press:	(1) Radio Mode	(2) Media Mode	(3) Phone Mode
	Uconnect® Voice Command (VR) Button	AM/FM & Satellite Brand Control	Media Devices Control	-
	GENERAL			
	Uconnect® Phone Pick Up Button	-	-	Call Initiation, Call Management, Pre-formatted Voice Text Reply

Voice Command Examples – Uconnect® 5.0

GENERAL	
Anytime	<p style="text-align: center;">“Go to Radio” (Media, Phone) – Compass, Settings, and More functions are not Voice Command accessible</p> <p style="text-align: center;">“Cancel”</p> <p style="text-align: center;">“Help” (to listen to suggested commands specific to current need)</p> <p style="text-align: center;">“Repeat”</p>

RADIO	
AM/FM	“Tune to AM950”, “Tune to 95.5FM (preset 5)
Satellite Band Control	“Tune to Satellite Channel 80’s on 8”, Tune to Satellite Channel 32 (preset 4)
MEDIA	
Media Devices Control (Functionality is dependent on compatibility between devices and radio)	“Browse” (show) “artist” (albums, music) “Show paired phones” (devices) “Play song – Maple Leaf Rag” (artist - Scott Joplin, genre - rock, album - Ragtime Favorites)
PHONE	
Call Initiation (Requires that phone has been Bluetooth® paired with radio)	“Dial 123-456-7890” (phone number) “Call John Smith mobile” (home, office, other) “Redial” “Show outgoing” (recent) “calls”
Call Management	“Search for John Smith” (any contact name in address book) “Show (display list) contacts”

Voice Text Reply (Radio audibly recognizes these 18 pre-formatted SMS messages as you speak)

Forward one of 18 pre-formatted SMS messages to incoming calls/text messages:

“Yes.”

“No.”

“Okay.”

“I can’t talk right now.”

“Call me.”

“I’ll call you later.”

“I’m on my way.”

“Thanks.”

“I’ll be late.”

“I will be <number> minutes late.”

“See you in <number> minutes”

“Stuck in traffic.”

“Start without me.”

“Where are you?”

“Are you there yet?”

“I need directions.”

“I’m lost.”

“See you later.”

SETTINGS MAIN MENU

CONTENTS

■ Settings Main Menu34
--------------------------------	-----

Settings Main Menu

Press the Settings hard-key to display the Settings Main Menu. The Settings Main Menu contains the following options:

- Display — Refer to “Understanding Your Instrument Panel”, “Uconnect® System” section in your vehicle Owner’s Manual for details.
- Clock — Refer to the “Radio” section for details.
- Safety/Assistance — Refer to “Understanding Your Instrument Panel”, “Uconnect® System” section in your vehicle Owner’s Manual for details.
- Lights — Refer to “Understanding Your Instrument Panel”, “Uconnect® System” section in your vehicle Owner’s Manual for details.
- Doors & Locks — Refer to “Understanding Your Instrument Panel”, “Uconnect® System” section in your vehicle Owner’s Manual for details.
- Heated Seats — Refer to “Understanding The Features Of Your Vehicle”, “Seats” section in your vehicle Owner’s Manual for details.
- Engine Off Options — Refer to “Understanding Your Instrument Panel”, “Uconnect® System” section in your vehicle Owner’s Manual for details.
- Compass Settings — Refer to “Understanding Your Instrument Panel”, “Uconnect® System” section in your vehicle Owner’s Manual for details.
- Audio — Refer to the Operating Instructions – Radio section in this manual for details.
- Phone/Bluetooth — Refer to the “Uconnect® Phone” section in this manual for details.
- SiriusXM Satellite Radio Setup — Refer to the “Radio” section in this manual for details.

MORE MAIN MENU

CONTENTS

■ More Main Menu36
----------------------------	-----

More Main Menu

Press the More hard-key to display the More Main Menu. The More Main Menu contains the following options:

- Time — Refer to the Uconnect® 5.0 “Radio Mode” section in this manual for details.

SAFETY GUIDELINES

CONTENTS

■ Safety Guidelines38
-------------------------------	-----

Safety Guidelines

WARNING!

ALWAYS drive safely with your hands on the steering wheel. You have full responsibility and assume all risks related to the use of the Uconnect® features and applications in this vehicle. Only use Uconnect® when it is safe to do so. Failure to do so may result in an accident involving serious injury or death.

Ensure that all persons read this manual carefully before using the system. It contains instructions on how to use the system in a safe and effective manner.

Please read and follow these safety precautions. Failure to do so may result in injury or property damage.

- Glance at the screen only when necessary and safe to do so. If prolonged viewing of the screen is necessary, park in a safe location and set the parking brake.
- Stop use immediately if a problem occurs. Failure to do so may cause injury or damage to the product. Return it to your authorized dealer to repair.
- Make certain that the volume level of the system is set to a level that still allows you to hear outside traffic and emergency vehicles.

Safe Usage of the Uconnect® System

- Read all instructions in this manual carefully before using your system to ensure proper usage!
- Your system is a sophisticated electronic device. Do not let young children use your system.
- Permanent hearing loss may occur if you play your music or the system at loud volumes. Exercise caution when setting the volume on your system.
- Driving is a complex activity that requires your full attention. If you're engaged in driving or any activity that requires your full attention, we recommend that you not use your system.

NOTE: Many features of this system are speed dependent. For your own safety, it is not possible to use some of the touch screen features while the vehicle is in motion.

- Keep drinks, rain, and other sources of moisture away from your system. Besides damage to your system, moisture can cause electric shocks as with any electronic device.

Touch Screen

- Do not touch the screen with any hard or sharp objects (pen, USB stick, jewelry, etc.) which could scratch the touch screen surface!
- Do not spray any liquid or caustic chemicals directly on the screen! Use a clean and dry micro fiber lens cleaning cloth in order to clean the touch screen.
- If necessary, use a lint-free cloth dampened with a cleaning solution, such as isopropyl alcohol, or an isopropyl alcohol and water solution ratio of 50:50. Be sure to follow the solvent manufacturer's precautions and directions.

Disc Drive

- Do not insert any damaged, warped, scratched or dirty Discs into the Disc player.
- Discs that have been modified with an adhesive label should not be used in the Disc player.
- Do not insert more than one Disc at a time into the drive slot.

FCC Declaration

This device complies with Part 15 of the FCC Rules and with Industry Canada license-exempt RSS standard(s). Operation is subject to the following two conditions: (1) this device may not cause harmful interference, and (2) this device must accept any interference received, including interference that may cause undesired operation.

NOTE: This equipment has been tested and found to comply with the limits for a Class B digital device, pursuant to Part 15 of the FCC Rules. These limits are designed to provide reasonable protection against harmful interference in a residential installation. This equipment generates, uses and can radiate radio frequency energy and, if not installed and used in accordance with the instructions, may cause harmful interference to radio communications. However, there is no guarantee that interference will not occur in a particular installation.

If this equipment does cause harmful interference to radio or television reception, which can be determined by turning the equipment off and on, the user is encouraged to try to correct the interference by one or more of the following measures: - Increase the separation between the equipment and receiver. - Consult the dealer or an experienced radio technician for help.

Safety Information

Exposure to Radio Frequency Radiation

The radiated output power of the this internal wireless radio is far below the FCC radio frequency exposure limits. Nevertheless, the wireless radio shall be used in such a manner that the radio is 20 cm or further from the human body.

The internal wireless radio operates within guidelines found in radio frequency safety standards and recommendations, which reflect the consensus of the scientific community.

The radio manufacturer believes the internal wireless radio is safe for use by consumers. The level of energy emitted is far less than the electromagnetic energy emitted by wireless devices such as mobile phones. However, the use of wireless radios may be restricted in some situations or environments, such as aboard airplanes. If you are unsure of restrictions, you are encouraged to ask for authorization before turning on the wireless radio.



14UC5-526-AB
Second Edition
Uconnect® 5.0

Chrysler Group LLC
Printed in the USA



DODGE 

CHRYSLER 

Jeep 

